

Center of hole  
14"

Center of Hole  
6"

4 Lift Lugs per Hopper  
2 on each side

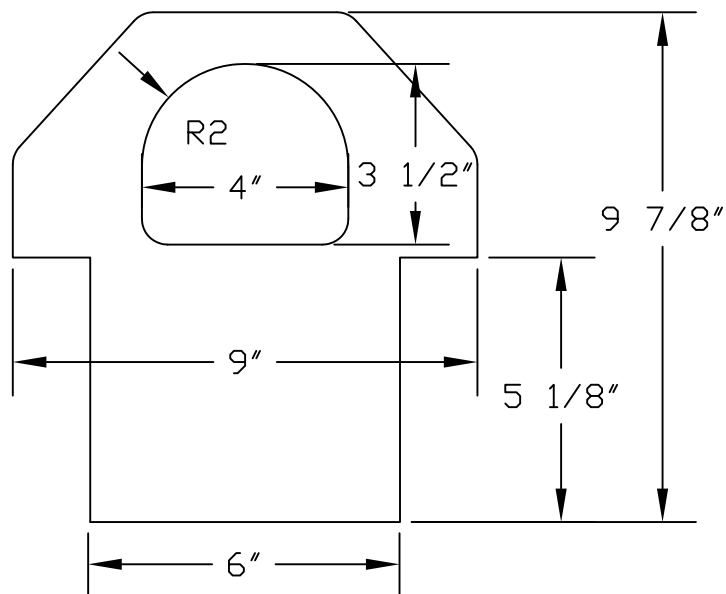

Note: All dimensions are approximate some dimensions may vary slightly per hopper

McCullough Ind., Inc.			
Lift Lugs			
SIZE B	FSCM NO.	DWG NO.	REV A
SCALE None		SHEET 1 OF 1	REVISED MAY 90